

# ステンレス製アダプター

材 質 : SUS304  
 最高圧力 : 70MPa(700kg/cm<sup>2</sup>)  
 常用圧力 : 35MPa(350kg/cm<sup>2</sup>)

## 90°エルボ 21

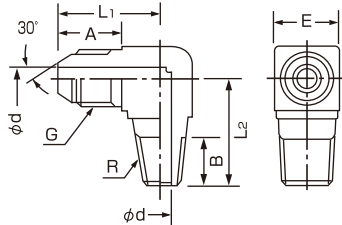
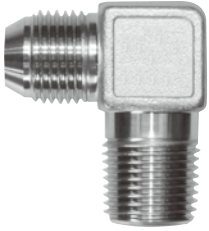

部品番号	R×G (PT×PF)	A	B	L <sub>1</sub>	L <sub>2</sub>	φd	E
90-21-02	1/8"	13	9	20	21	4	14
90-21-04	1/4"	16	11	24	25	5.5	17
90-21-06	3/8"	18	13	28	30	8	19
90-21-08	1/2"	20	15	32	36	11	24
90-21-12	3/4"	22	17	37	43	16	30
90-21-16	1"	23	19	41	50	22	36

## 90°エルボ 22

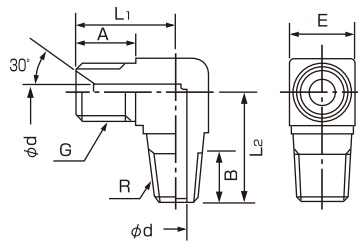
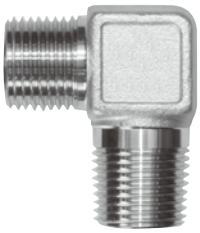

部品番号	R×G (PT×PF)	A	B	L <sub>1</sub>	L <sub>2</sub>	φd	E
90-22-02	1/8"	11	9	18	21	4	14
90-22-04	1/4"	13	11	21	25	5.5	17
90-22-06	3/8"	15	13	25	30	8	19
90-22-08	1/2"	18	15	30	36	11	24
90-22-12	3/4"	20	17	35	43	16	30
90-22-16	1"	22	19	40	50	22	36

## 45°エルボ 21

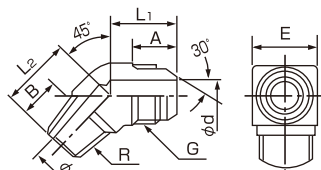

部品番号	R×G (PT×PF)	A	B	L <sub>1</sub>	L <sub>2</sub>	φd	E
45-21-02	1/8"	13	9	18	17	4	14
45-21-04	1/4"	16	11	22	19	5.5	17
45-21-06	3/8"	18	13	25	23	8	19
45-21-08	1/2"	20	15	28	27	11	24
45-21-12	3/4"	22	17	32	31	16	30
45-21-16	1"	23	19	35	34	22	36

## 45°エルボ 22

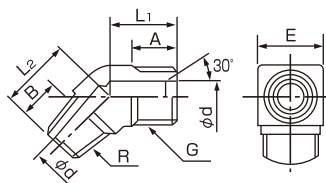
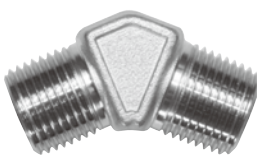

部品番号	R×G (PT×PF)	A	B	L <sub>1</sub>	L <sub>2</sub>	φd	E
45-22-02	1/8"	11	9	18	17	4	14
45-22-04	1/4"	13	11	19	19	5.5	17
45-22-06	3/8"	15	13	22	23	8	19
45-22-08	1/2"	18	15	26	27	11	24
45-22-12	3/4"	20	17	30	31	16	30
45-22-16	1"	22	19	34	34	22	36

### オス×オス10×21

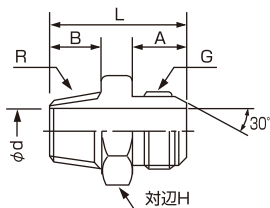
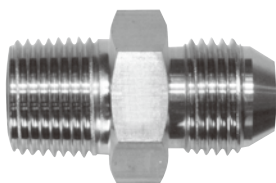

部品番号	R×G (PT×PF)	A	B	L	ϕd	H
10-21-02	1/8"	13	10	29	4	14
10-21-04	1/4"	14	13	35	5.5	19
10-21-06	3/8"	16	15	40	8	22
10-21-08	1/2"	19	18	47	11	27
10-21-12	3/4"	21	20	53	16	36
10-21-16	1"	23	23	58	22	41

### オス×オス10×22

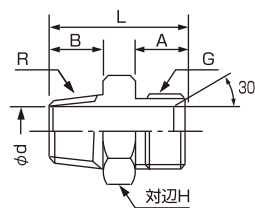
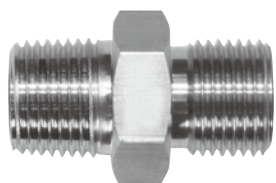

部品番号	R×G (PT×PF)	A	B	L	ϕd	H
10-22-02	1/8"	10	10	26	4	14
10-22-04	1/4"	13	13	34	5.5	19
10-22-06	3/8"	15	15	38	8	22
10-22-08	1/2"	18	18	46	11	27
10-22-12	3/4"	20	20	52	16	36
10-22-16	1"	22	23	57	22	41

### オス×オス13×22

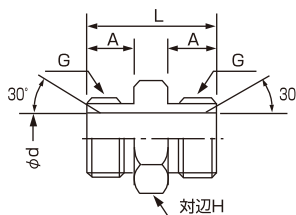
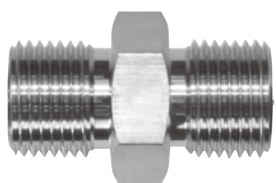

部品番号	G×G (PF×PF)	A	L	ϕd	H
13-22-02	1/8"	10	28	4	14
13-22-04	1/4"	13	34	5.5	19
13-22-06	3/8"	15	38	8	22
13-22-08	1/2"	18	46	11	27
13-22-12	3/4"	20	52	16	36
13-22-16	1"	22	57	22	41

### オス×メス15×22

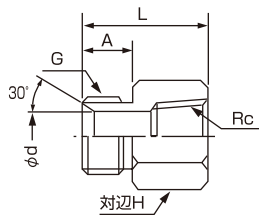
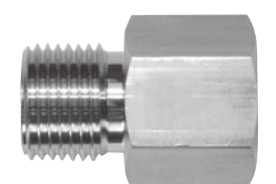

部品番号	Rc×G (PT×PF)	A	L	ϕd	H
15-22-02	1/8"	10	26	4	14
15-22-04	1/4"	13	32	5.5	19
15-22-06	3/8"	15	34	8	22
15-22-08	1/2"	18	41	11	27
15-22-12	3/4"	20	46	16	36
15-22-16	1"	22	50	22	41

### 20.メスユニオン-オス

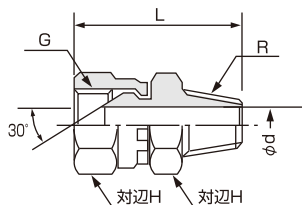

部品番号	R×G (PT×PF)	L	ϕd	H
20-04	1/4"	37	5.5	19
20-06	3/8"	42	8	22
20-08	1/2"	50	11	27
20-12	3/4"	55	16	36
20-16	1"	60	22	41

### 25.メスユニオン-メスユニオン

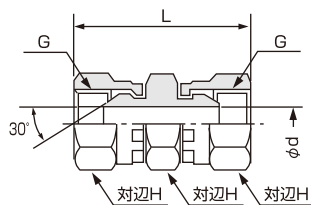

部品番号	G×G (PF×PF)	L	ϕd	H
25-04	1/4"	40	5.5	19
25-06	3/8"	45	8	22
25-08	1/2"	54	11	27
25-12	3/4"	58	16	36
25-16	1"	63	22	41

### 30.メスユニオン-メス

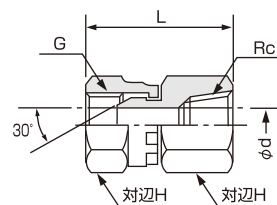

部品番号	Rc×G (PT×PF)	L	ϕd	H
30-04	1/4"	33	5.5	19
30-06	3/8"	37	8	22
30-08	1/2"	45	11	27
30-12	3/4"	49	16	36
30-16	1"	53	22	41